



SIDE SLIDER INSTALLATION GUIDE



June 2025

INSTALLATION: SIDE SLIDER



For installation questions, contact our
Technical Director at **419-866-7705, ext 1033**.
For all other inquiries, call us at **704-762-1911**

Vertical Section

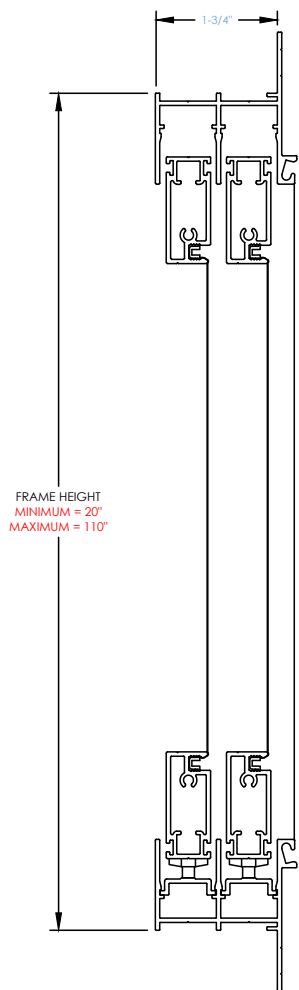

- 1. All Porch Conversions windows have a 7/8" flange and are designed to be fastened through this flange into a post/structure.**
- 2. You will need the following tools for installation of this product:**
 - Tape measure
 - Level
 - Pencil
 - Cordless Drill/Driver
 - 1/8" drill bit
 - #2 Robertson Square Drive bit
 - Utility knife with a sharp blade (for trimming the screen)
 - Caulk gun
 - 100% clear silicone caulk
 - Shims (composite or plastic recommended)
- 3. Before installing, open and thoroughly check the window for damage, correct size, aluminum color, vinyl color and screen type.**
- 4. For larger windows, you might want to remove the sashes and set them aside to make the window lighter for installation.**
- 5. Check the window opening to be sure it is plumb, level, and square.**

Horizontal Sections

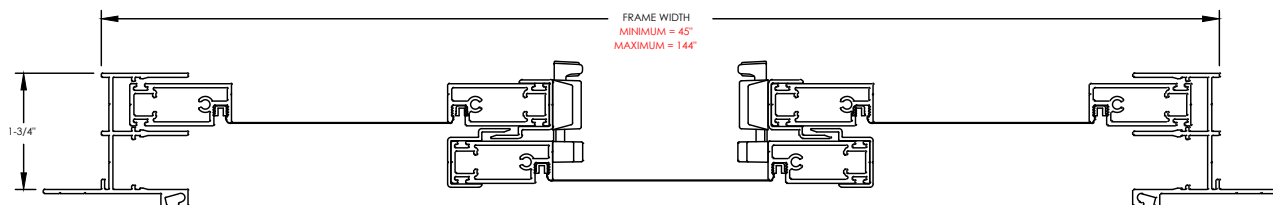
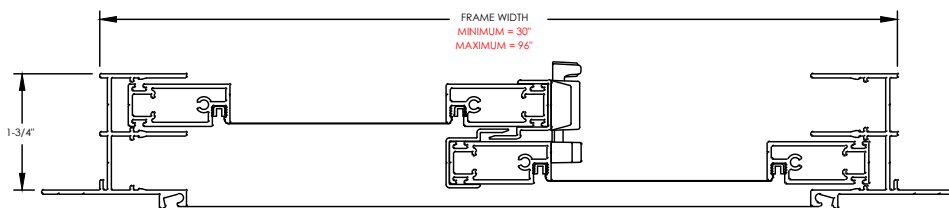

INSTALLATION: SIDE SLIDER



For installation questions, contact our
Technical Director at **419-866-7705, ext 1033**.
For all other inquiries, call us at **704-762-1911**

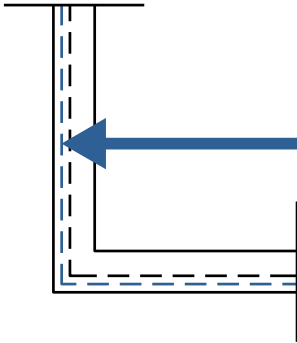

1.0 Use outer groove for screws

6. Using a tape measure and pencil, mark the location of your mounting screws on the mounting flange.

- There are 2 lines or grooves on the mounting flange, and you want to locate your screws on the outermost line or groove.
 - See image 1.0
- At each corner, mark 2" in each direction for screws.
 - See image 2.0

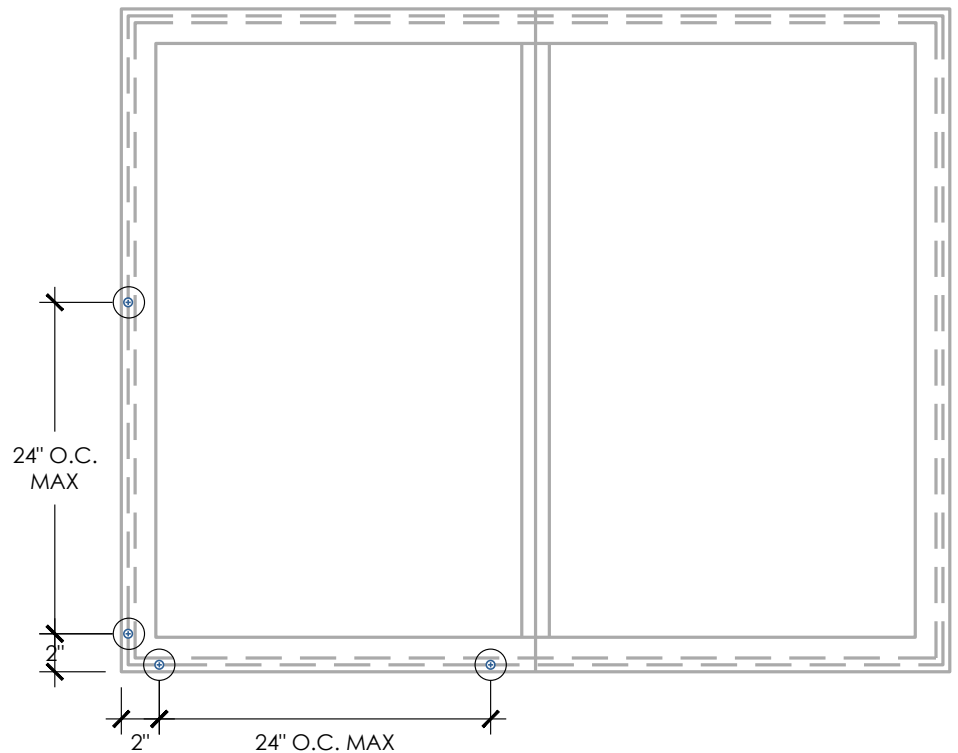

2.0 Screw locations

- From there, mark for additional screws a maximum of 24" on center on the sides, top and bottom.
- Pre-drill all holes with an 1/8" drill bit.

7. Before applying any caulk, test fit the window in the opening.

- Center window left to right in the opening and shim as needed to center the window top to bottom.

INSTALLATION: SIDE SLIDER



For installation questions, contact our
Technical Director at **419-866-7705, ext 1033**.
For all other inquiries, call us at **704-762-1911**

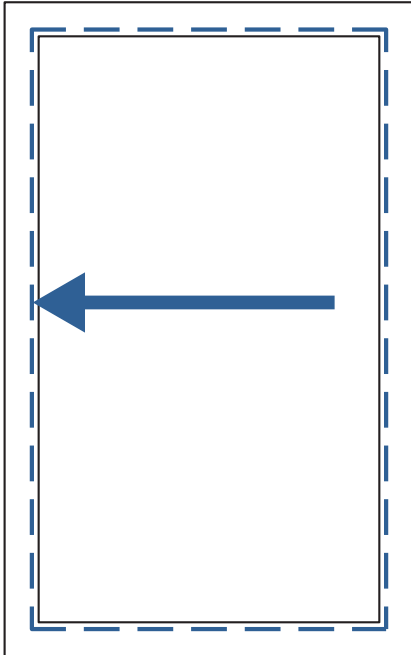

3.0 Apply caulk around perimeter of R.O.

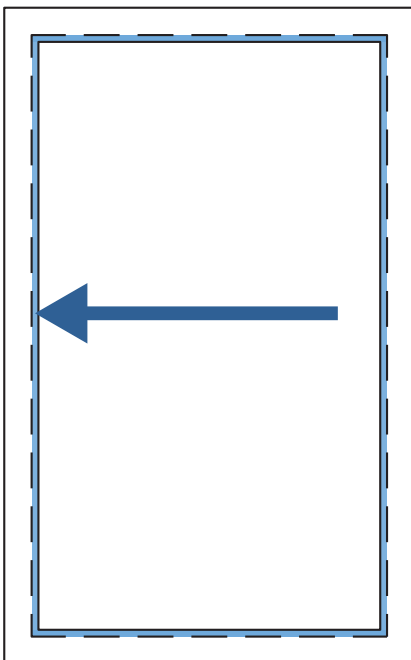

4.0 Leave approx. 1/8" gap between frame & R.O.

8. Remove the window and apply a bead of caulk around the entire opening (not the window frame).

- See image 3.0
- Set the window in while the caulk is wet.

9. Make sure the window is sitting level and square in the opening. Then secure the bottom corners with the #8 x 3/4" self-drilling color matched screws supplied. There should be a 1/8" gap between the frame and the rough opening (R.O.) all the way around. See image 4.0.

10. Check one side of the window and straighten as needed. Then install screws from the bottom to the top with the top corner being the last screw.

11. Pick a measuring point to measure the width of the window at the bottom. Using that number, from bottom to top, check the width and straighten the other side of the window and secure with the #8 x 3/4" color matched screws supplied.

- See image 5.0

12. For muller units, please follow the directions on the 4-track install guide.

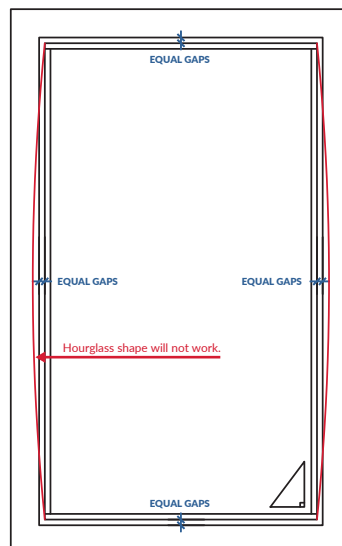

5.0 Equal gaps